

DBA015

REV.	DESCRIPTION	DATE	ENG	ECO #	APPR
2	REMOVE PAN TUBE	20JUL04	LR		
3	CHANGED PARTS FOR LARGER PAN TUBE DESIGN	28APR05	DF		

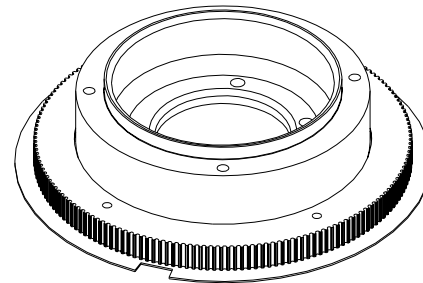
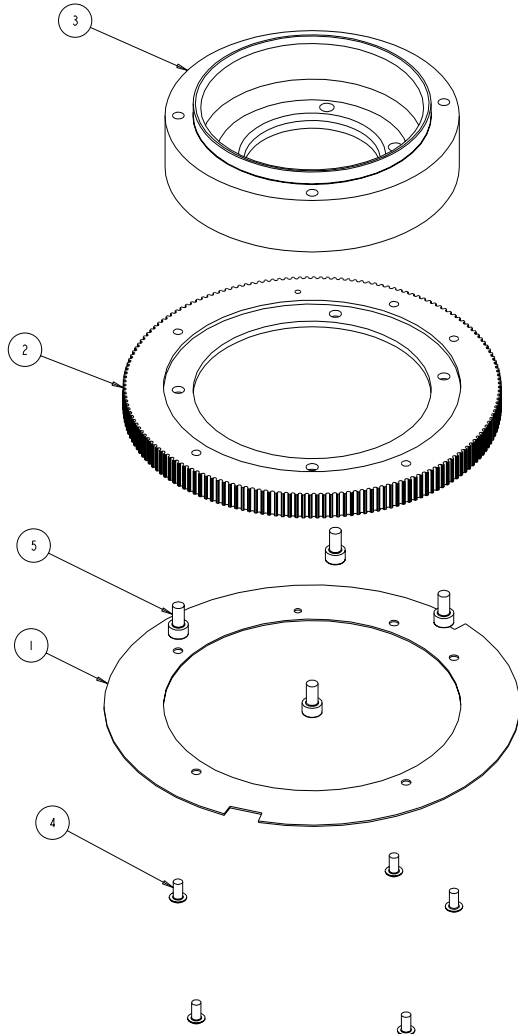

NOTES:
1. PARTS TO BE FREE OF BURRS AND/OR SHARP EDGES

ITEM NO.	QTY.	FILENAME	PART NO.	REV	DESCRIPTION
5	4	SCREWM5AC10SSP	91100510	.	SCREW, M5 SOCKET 10 SS, W/PATCH
4	5	SCREWM4AB08BZP	91010408	.	SCREW, M4 BUTTON 08 BZ W/PATCH
3	1	DB311	99400092	A	HUB, YOKE ADAPTER, DL2
2	1	DB301	99430111	A	GEAR, PULLEY, 170T PAN DRIVE, DL2
1	1	DB185	99360045	A	FLANGE, PAN SENSOR, DL2

BILL OF MATERIALS

UNLESS OTHERWISE SPECIFIED	RELEASE DATE:	CE:	2105 GRACY FARMS LANE AUSTIN, TEXAS 78758 (512) 836-2242 FAX (512) 832-4128 ***** http://www.highend.com	
DIMENSIONAL TOLERANCES:	ENG:	QA:		
0 PLACE DECIMAL = ±0.38	ME:			
1 PLACE DECIMAL = ±0.25	MEG:	DRW: K. BICKERS		
2 PLACE DECIMALS = ±0.13				
ANGLES = ±0.5°				
FOR PAINTED PARTS REFER TO ENG. SPEC. MANUAL WI-0592	MATERIAL:	FINISH:		
	CHARTED	NONE		
MIN. DRAFT				
MIN. RADI				
FLATNESS	INTERPRET DIMENSIONS PER ASME Y14.5M-1994			
THICKNESS	THIRD ANGLE PROJECTION			
VOLUME	DIMENSIONS ARE IN MILLIMETERS			
	SI METRIC A1		PART NO. INTERNAL DBA015	REV. NA
			DO NOT SCALE	SHEET: 1 OF 1

PROPRIETARY NOTICE:
THIS DOCUMENT CONTAINS CONFIDENTIAL AND PROPRIETARY INFORMATION OF HIGH END SYSTEMS INC., (ALSO DBA LIGHTWAVE RESEARCH) AND IS GIVEN TO THE RECEIVER IN CONFIDENCE. THE RECEIVER ACCEPTS AND AGREES THAT, EXCEPT AS AUTHORIZED BY HIGH END SYSTEMS, THE RECEIVER WILL NOT PERMIT THE USE OF THE DOCUMENT OR ANY COPY THEREOF ON THE INFORMATION THEREIN. WILL NOT COPY OR PERMIT COPYING THE DOCUMENT WILL NOT DISCLOSE TO OTHERS EITHER THE DOCUMENT OR THE INFORMATION THEREIN, AND WILL UPON COMPLETION OF THE NEED TO RETAIN THE DOCUMENT, OR UPON DEMAND, RETURN THE DOCUMENT WITHOUT RETAINING ANY OF THE INFORMATION CONTAINED THEREIN IN ANY FORM WHATSOEVER.